



# GRAVITYWORKS™ 2.0L COMPLETE KIT

PUMP-FREE WATER FILTRATION SYSTEM

ENG INSTRUCTIONS

## WARNING

### BIOLOGICAL HAZARD

There are hazards associated with backcountry travel and the use of water filters. Drinking untreated water may expose you to harmful microorganisms and increase your risk of gastrointestinal illness. Using this filter improperly increases your risk of exposure to harmful microorganisms and increases your risk of gastrointestinal illness. Reduce your chances of becoming sick by following the warnings and instructions in this manual and educating yourself on backcountry water safety.

**YOU ARE RESPONSIBLE FOR YOUR OWN SAFETY AND THE SAFETY OF THOSE IN YOUR GROUP. PLEASE USE GOOD JUDGMENT.**

Never use the GravityWorks™ to filter seawater or chemically contaminated water, such as water from mining tailing ponds or near large agricultural operations. The GravityWorks does not make drinkable water from these sources and does not remove all viruses, chemicals and radioactive materials, or particles smaller than 0.2 microns.

Keep the hoses and other potentially contaminated parts away from filtered water to prevent cross contamination.

READ, UNDERSTAND, AND FOLLOW ALL instructions and warnings in this manual before using this filter. Failure to follow warnings and instructions may result in gastrointestinal illness.

**IMPORTANT**

Read and understand this entire manual carefully before assembling or using this water filter. Keep this manual for future reference. If you do not understand this manual or have any questions, please call Cascade Designs at 1-800-531-9531.

Printed on 50% Recycled (30% PCR) Paper, Processed Chlorine/acid Free.

RECYCLED | RECYCLABLE

info@cascaadedesigns.com  
www.platy.com  
1-800-531-9531 or 206-505-9500  
4000 First Avenue South, Seattle, WA 98134 USA

For product information and service contact  
**CASCADE DESIGNS, INC.**

BOTTLE KIT		COMPLETE KIT	
Dirty Reservoir	10.5 x 6 in. / 27 x 15 cm	Dirty Reservoir	10.5 x 6 in. / 27 x 15 cm
Male Quick Disconnect	9.5oz / 269g	Male Quick Disconnect	9.5oz / 269g
Universal Bottle Adapter		Universal Bottle Adapter	
Push/Pull Adapter		Push/Pull Adapter	
Shutoff Clamp		Shutoff Clamp	
Filter Cartridge w/ Bumpers		Filter Cartridge w/ Bumpers	
Clean Hose (long)		Clean Hose (long)	
Dirty Hose (short)		Dirty Hose (short)	
Male Quick Disconnect		Male Quick Disconnect	
Dirty Reservoir		Dirty Reservoir	
Contents		Contents	
Dimensions		Dimensions	
Flow Rate	~ 1500 liters (depends on water conditions)	Flow Rate	1.5 L / min. (depends on water conditions)
Filter Life	~ 1500 liters (depends on water conditions)	Filter Life	~ 1500 liters (depends on water conditions)
Filter Media	Hollow Fiber Membrane	Filter Media	Hollow Fiber Membrane
Storage Temperature	Above 32 F / 0 C (Do Not Freeze)	Storage Temperature	Above 32 F / 0 C (Do Not Freeze)

### TROUBLESHOOTING

Problem	Cause	Solution
Leaking Female Quick Disconnect	Clogged Female Quick Disconnect	Rinse Female Quick Disconnect
Decreased/no water flow	Trapped air in Filter Cartridge	Filter 1/8 L water into Clean Container and then lift it above Dirty Reservoir to purge air (see Step 4)
	Clogged filter	Backflush Filter Cartridge (see Step 5)
	Kinked hose	Straighten hose
	Disengaged Male Quick Disconnect	Push Male Quick Disconnect into fitting completely
	Closed Shutoff Clamp or Push/Pull Cap	Open Shutoff Clamp or Push/Pull Cap

For other concerns or questions, please see our FAQ's online at [www.platy.com/FAQ](http://www.platy.com/FAQ), or call Customer Service at 1.800.531.9531

### LONG-TERM STORAGE AND DISINFECTION

- Rinse Dirty Reservoir with clean water. (15+ days);
- Mix a solution of 2 drops of household bleach (without fragrance or dyes) to 1 liter of water in Dirty Reservoir, and zip closed.
- Assemble Filter System with Shutoff Clamp closed. Place end of Clean Hose in sink and hold or hang Dirty Reservoir above sink.
- Open Shutoff Clamp and let solution filter through system.
- Rinse all other parts with clean water.
- Air or towel-dry all parts completely.
- Note - The inside of the filter cartridge will not dry completely, but the bleach will prevent the growth of microorganisms or biofilm.
- Pack and store in Storage Sack.

### TIPS

**TAKE ONLY WHAT YOU NEED**

When filtering into small-diameter openings and hydration hoses, the two-part Universal Bottle Adapter lets you leave the threaded outer portion at home to save space and weight.

**FILTER CARTRIDGE**

Extend your filter's lifespan by backflushing every 2-4 liters (Step 5). If backflushing fails to restore water flow, replace cartridge.

On extended trips, bring along a spare cartridge.

Learn the very easy Filter Integrity Test. If the cartridge freezes or is dropped hard, test it to be sure it is not damaged.

**WATER COLLECTION AND PREPARATION**

Use the cleanest, clearest water available. Avoid water that is muddy, silty or tea-colored if at all possible.

To treat water with suspected waterborne viruses, use an approved disinfectant such as MSR® Aquatabs® ([www.msrgear.com](http://www.msrgear.com)). For more information, see the Centers for Disease Control Web site: [www.CDC.gov](http://www.CDC.gov).

**OPERATION**

To maximize water flow, hang or hold the Dirty Reservoir as high as possible without putting tension on the hoses or pulling the clean container off the ground.

Trapped air in the top of the Filter Cartridge may reduce flow rates. Purge trapped air at the beginning of each use (Step 4).

"Dirty"-side connection points are GREY or BLACK and "Clean"-side connection points are BLUE or WHITE. To avoid cross contamination when filtering water, do not let any BLUE/WHITE components come into contact with unfiltered water and keep GREY/BLACK components away from filtered water. If you suspect your filter has become cross-contaminated, see instructions for Long-Term Storage and Disinfection.

### LIMITED WARRANTY/LIMITATIONS OF REMEDIES AND LIABILITY

**USA AND CANADA**

Limited Warranty Cascade Designs, Inc. ("Cascade"), under intended use and maintenance, warrants the enclosed product ("Product") to be free from defects in materials and workmanship for the life of the product. No warranty against defects in materials and workmanship will apply if Product is (i) altered in any way, (ii) used for purposes inconsistent with Product's intended purpose or design, or (iii) improperly maintained. Warranty will furthermore be voided where Owner/user (i) failed to follow Product instructions or warnings or (ii) subjected Product to misuse, abuse, or neglect.

During the warranty period, original Product parts determined by Cascade to be defective in materials or workmanship will be repaired or replaced at Owner's sole remedy. Cascade reserves the right to replace any discontinued product with a new product of comparable value and function. A returned product deemed irreparable becomes the property of Cascade and will not be returned.

EXCLUDING THE LIMITED WARRANTY PROVIDED ABOVE, CASCADE, ITS AFFILIATES AND THEIR SUPPLIERS, TO THE MAXIMUM EXTENT PERMITTED BY LAW, MAKE NO WARRANTIES, EXPRESS OR IMPLIED, AND DISCLAIM ALL WARRANTIES, DUTIES AND CONDITIONS, WHETHER EXPRESSED OR IMPLIED, WITH RESPECT TO THE PRODUCT INCLUDING WITHOUT LIMITATION ANY IMPLIED WARRANTIES OF MERCHANTABILITY, AGAINST LATENT DEFECTS, FITNESS FOR A PARTICULAR PURPOSE, OR CORRESPONDENCE TO DESCRIPTION.

Warranty Service. To obtain service under this warranty, the warranty-eligible Product must be presented to a Cascade authorized dealer, in the United States and Canada, warranty service may also be obtained by calling 1.800.531.9531 (M-F, 8:00 a.m. - 4:30 p.m., PDT). Owner is responsible for all costs associated with returning Product to Cascade for service. Where at its sole discretion Cascade deems Product eligible for warranty repair or replacement, Cascade will pay the shipping and handling associated with returning repaired or replaced Product to Owner. In instances where Cascade deems a returned product ineligible for warranty service, Cascade will, if possible, repair product for a reasonable charge that includes return shipping and handling. For warranty return service details, please go to [www.platypushipitation.com](http://www.platypushipitation.com).

Limitation of Remedies. Should a court of competent jurisdiction find the limited warranty set forth above breached, Cascade's only obligation will be, at its option, either repair or replace Product. Should the aforementioned purchase price of its essential purchase, Cascade will, in exchange for return of Product, refund to Owner Product's original purchase price. THE FOREGOING REMEDY IS THE SOLE AND EXCLUSIVE REMEDY OF THE PURCHASER AGAINST CASCADE, ITS AFFILIATES AND THEIR SUPPLIERS, REGARDLESS OF LEGAL THEORY.

Limitation of Liability. Cascade's, its affiliates', and their suppliers' maximum liability is limited to incidental damages not to exceed the original purchase price of the Product. CASCADE, ITS AFFILIATES AND THEIR SUPPLIERS HEREBY DISCLAIM AND EXCLUDE ANY LIABILITY FOR ANY CONSEQUENTIAL OR OTHER DAMAGES RESULTING FROM ANY REASON WHATSOEVER. THIS EXCLUSION AND LIMITATION APPLIES TO ALL LEGAL THEORIES UNDER WHICH DAMAGES MAY BE SOUGHT, AND WILL APPLY EVEN IF ANY REMEDY FAILS OF ITS ESSENTIAL PURPOSE.

This limited warranty gives Owner specific legal rights. Owner may have additional rights, which may vary state to state. Always completely follow safety, use, operation, and maintenance instructions for this or any other Cascade product. European Union customer statutory rights are not affected.

www.platy.com

Cascade Designs, Inc.  
4000 First Avenue South, Seattle, WA 98134 USA  
1-800-531-9531 or 206-505-9500  
Dwyer Road, Middleton, County Cork, Ireland  
(+353) 21-4621400

For product service and information contact

### FILTER INTEGRITY TEST

- Backflush a minimum of 1/2 L of water.
- Remove Clean Hose.
- Blow air and check.
  - Cannot blow through filter = Fiber OK.
  - See steady stream of bubbles = Fiber broken. STOP! REPLACE CARTRIDGE.

## 1 INITIAL SET UP

Complete Steps A-B for the initial assembly of the GravityWorks™ 2.0L system. In the field, keep all parts (hoses, filter, adaptor & cap) connected to avoid cross-contamination. See Step 6, STORE, for recommended travel mode.

- A. Connect long Clean Hose to white Clean Hose Barb on Filter.

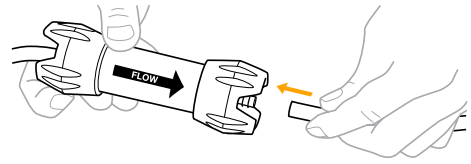

- B. Select the proper adapter for your Clean Container, connect to opposite end of Clean Hose and close cap.

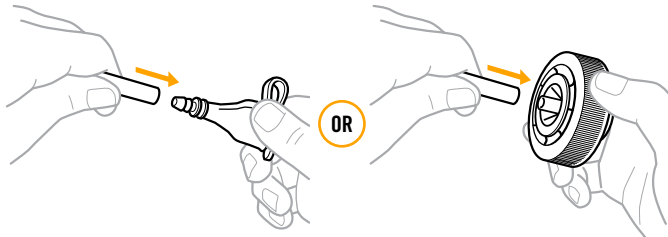

- i) Use Push/Pull Adapter for Platypus® 2L bottle or hydration system shut-off valves. (Complete Kit only)
- ii) Use Universal Bottle Adapter for most bottles and hydration systems. (Complete Kit only)

## 2 COLLECT & CONNECT

- A. Fill Dirty Reservoir with the cleanest water available. Zip closed.
- B. Hang or place Dirty Reservoir approx. 3–4 ft. above where Clean Container will be.
- C. Check that Shutoff Clamp is closed.
- D. Connect the Quick Disconnect to the Dirty Reservoir.

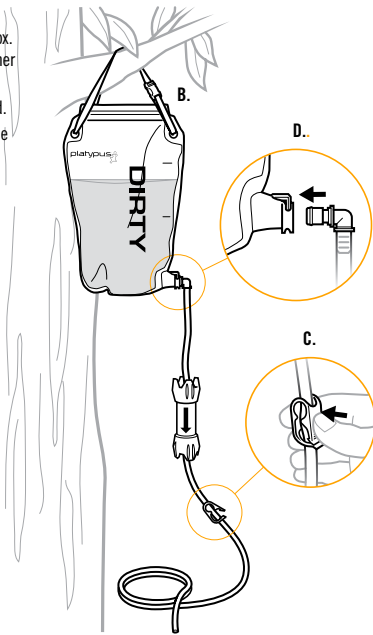

### WARNING

To avoid contamination when filtering water, never splash dirty or unfiltered water into clean container.

## 3 ATTACH CLEAN CONTAINER

### FOR PLATYPUS™ 2L BOTTLE (with Push/Pull cap):

- A. Open Adapter cap.
- B. Press Adapter over Push/Pull Cap. (Fig. 1)
- C. Ensure Push/Pull Cap is open.

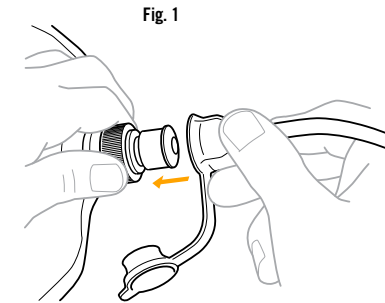

### FOR PLATYPUS™ HYDRATION SYSTEMS:

- A. Remove Push/Pull Adapter from Shutoff Valve Adapter. (Fig. 1)
- B. Pull Bite Valve off Shutoff Valve. (Not shown)
- C. Insert Shutoff Valve Adapter into Platypus or Camelbak® Shutoff Valve (Fig. 2).

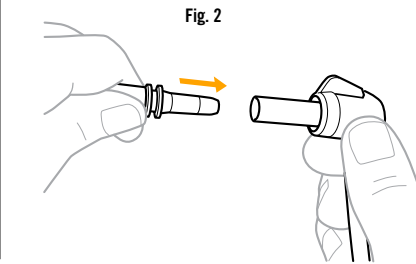
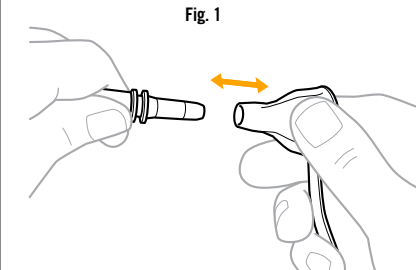

### FOR BOTTLES:

- A. Thread Universal Bottle Adapter, as shown, onto widemouth openings such as those found on as MSR® Dromedary bags, MSR® Alpine Bottles, and Nalgene® Bottles. (Or press complete Bottle Adapter onto Kleen Kanteen® bottle.)

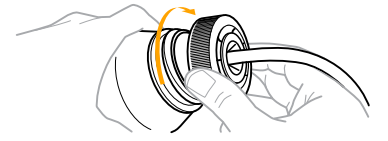

- B. Press Inner Bottle Adapter into Platypus SoftBottles™ or other small mouth containers such as Sigg® or Nalgene® bottles.

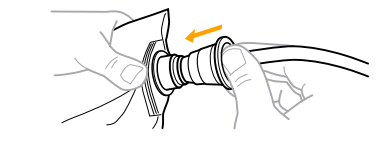

- C. Insert most hydration system hoses and shutoff valves directly into central adapter port.

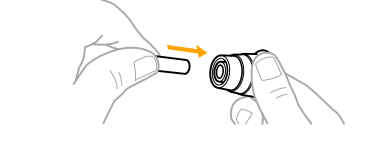

## 4 FILTER

- A. Start flow by releasing the Shutoff Clamp.
- B. For maximum flow, once a small amount of water has been collected (approx. 1/8 L), lift the Clean Container above the Dirty Reservoir to purge air from the filter.
- C. Once air bubbles have cleared the hose above the filter, reposition the Clean Container below the Dirty Reservoir to continue filtering.

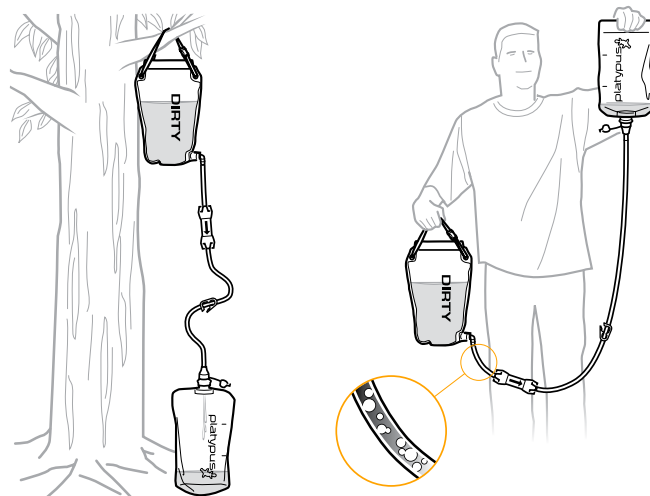

## 5 BACKFLUSH

To increase the life of your filter, follow this quick and easy backflush procedure\* every 2-4 liters:

- A. Before the Dirty Reservoir is empty, disconnect the Dirty hose at the Quick Disconnect fitting and raise your Clean Container above it. Allow water to run onto ground for four seconds, or until the water runs clear.
- B. Lower Clean Container, reconnect Quick Disconnect fitting and continue filtering.

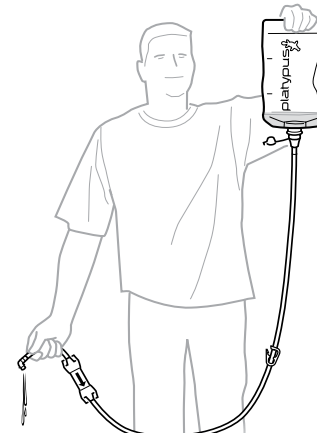

\*NOTE: This backflush is designed to work with all adapters and clean containers.

### WARNING

Handle Filter Cartridge carefully because a damaged filter cannot prevent exposure to harmful microorganisms. Test filter for damage if dropped. (See Filter Integrity Test.) If filter is damaged, discontinue use and replace cartridge.

## 6 STORE

- A. Disconnect the Clean Container and close.
- B. Remove the Quick Disconnect hose from Dirty Reservoir and drain remaining water from the system.
- C. Replace the Adapter Cap.
- D. Wrap hoses around filter body and place into mesh storage compartment. **NOTE:** Keep filter, outlet hose, Adapter and Adapter Cap connected to prevent cross-contamination.
- E. Roll Dirty Reservoir and place in non-mesh storage compartment.

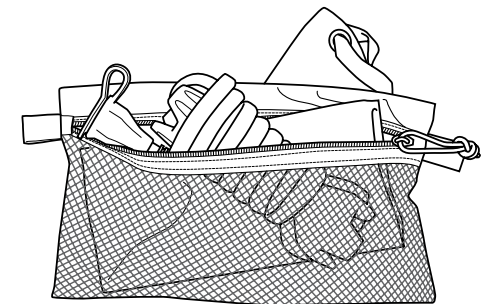

### WARNING

Disinfect filter thoroughly before long-term storage to prevent the growth of mold, mildew, and bacteria. Never use a dishwasher or microwave to disinfect parts because the high heat will damage or melt filter components.

Never allow Filter Cartridge to freeze because freezing the filter will permanently damage the internal fibers.

