

# Parts list for the *SP2* 4-gallon Knapsack Sprayer

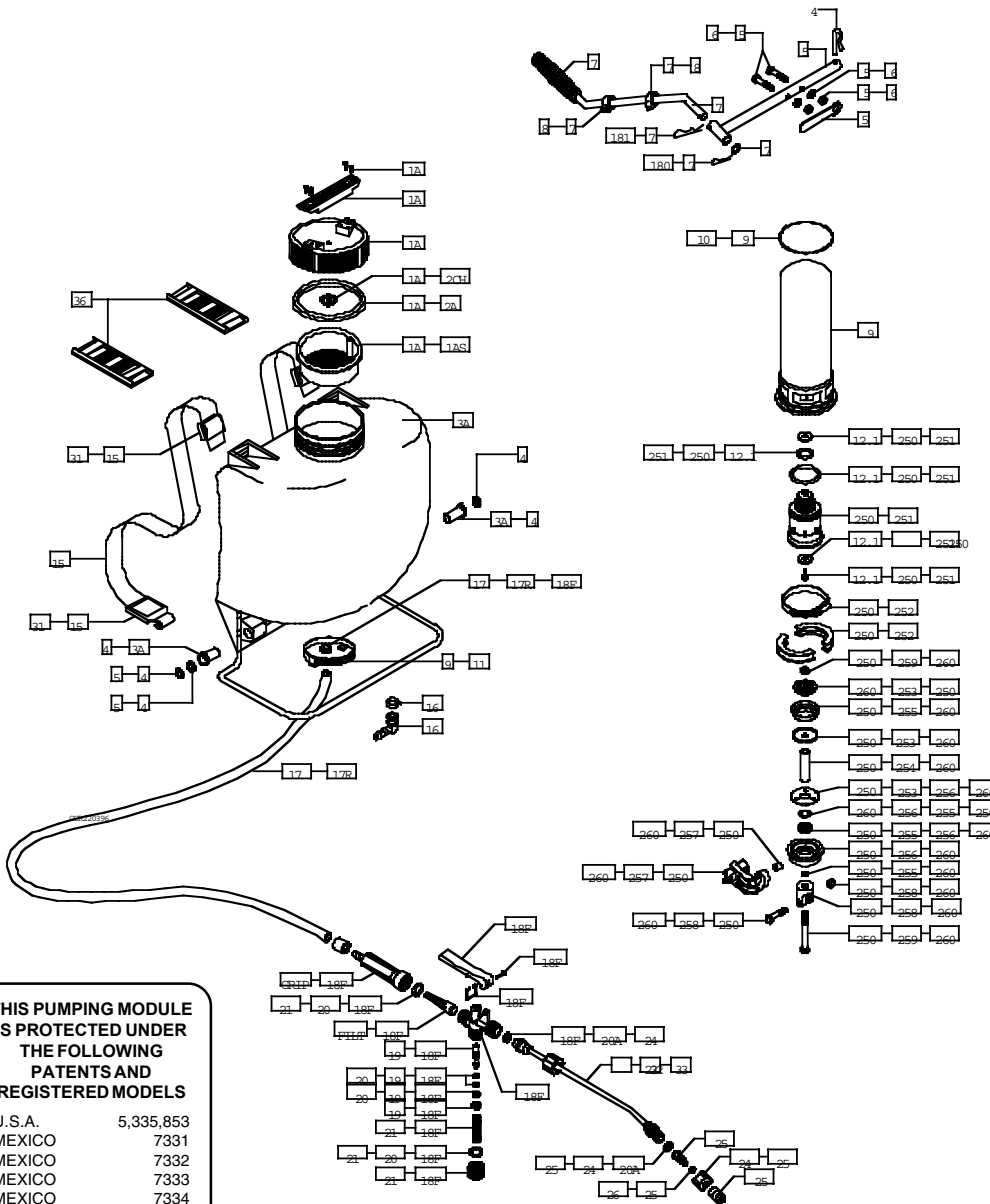

**THIS PUMPING MODULE IS PROTECTED UNDER THE FOLLOWING PATENTS AND REGISTERED MODELS**

U.S.A.	5,335,853
MEXICO	7331
MEXICO	7332
MEXICO	7333
MEXICO	7334
MEXICO	7335
MEXICO	7337
MEXICO	7338
OTHERS	PENDING

For your convenience, you may order any and all spare parts from our parts depot:

*SP Parts and Services, Inc.*  
(800) 286-0679



## PARTS LIST

- Kit 1A Cap w/seal & handle 6".
- Kit 1AS Strainer with venting hole 6".
- Kit 2A Seal for cap 6".
- Kit 2CH Check valve for cap.
- Kit 3A Tank w/nylon bearing.
- Kit 4 Nylon bearing.
- Kit 5 Pump lever (fold-back type).
- Kit 6 Screw and nut set.
- Kit 7 Pump handle (fold-back type).
- Kit 8 Plastic clip for pump handle.
- Kit 9 Pressure tank.
- Kit 10 Pressure tank "O"ring.
- Kit 11 Retention clamp.
- Kit 12.1 "O"ring & washer set diaphragm-piston.
- Kit 15 Belt and clip.
- Kit 16 90 degree fitting
- Kit 17 Hose set.
- + Kit 17R Hose set (rubber)
- Kit 18F Complete spray pistol with brass spindle and filter. Spindle set.
- Kit 19 Spindle "O"ring set.
- Kit 20A Rubber washer.
- Kit 21 Plug set.
- Kit 22 Brass spray wand.
- + Kit 23 Plastic spray wand.
- Kit 24 Nozzle holder.
- Kit 25 Adjustable brass nozzle with holder.
- + Kit 25JET Plastic spray tip set (2-8004 & 1-TK5).
- Kit 26 Spray tip "O"ring set.
- Kit 31 Belt hooks.
- + Kit 33 Aluminum spray wand
- Kit 36 Shoulder pads.
- Kit 180 Locking pin-pump handle (small).
- Kit 181 Locking pin-pump handle (large).
- Kit 250 Complete pump module.
- Kit 251 Complete cylinder for sealed piston.
- Kit 252 Half moon jaws & clamp.
- Kit 253 Piston holder & stainless plates.
- Kit 254 Brass hollow shaft.
- Kit 255 Viton piston and seals.
- Kit 256 Complete base & seals.
- Kit 257 Nylon crank lever & brass bushing.
- Kit 258 Lever holding saddle with bolt & nut.
- Kit 259 Bolt & nut piston holder.
- Kit 260 Complete piston assembly.
- Kit FILT Filter for Kit 18F.
- Kit GRIP Grip handle for Kit 18F.

**NOTE: + Not supplied with unit. See sheet of accessories.**

**NOTE:**

For best results, the sprayer should be pumped every 5 seconds on a continuous basis. This will maintain your spraying pressure. If you do not pump, you will not have pressure to spray



PO Box 7098, Santa Monica, CA 90406  
(310) 449-1492 (800) 457-3440 FAX (310) 449-6912

If you have a question or a problem please call us at

**1-800-457-3440**

We will answer any question you may have.